

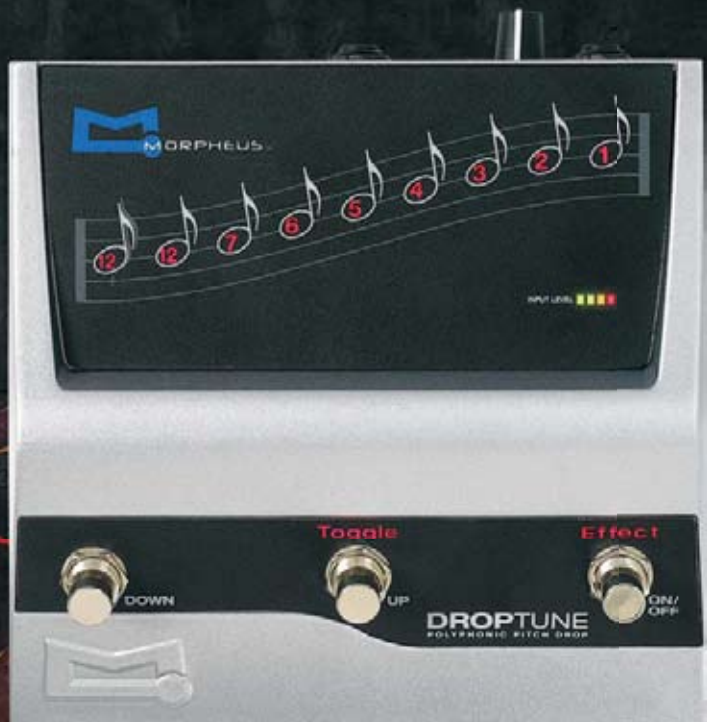

The Morpheus DropTune™ gives your guitar instant polyphonic drop tuning in 1/2-step decrements up to 3 1/2 steps — plus full Octave and Octaver.



Now you can go from one pitch for a particular song to a different pitch on the next without having to retune your guitar or owning two, three or more guitars for various step-down de-tunings.

For example, play an E chord in standard tuning, then use this unique pedal to drop tune your guitar so the chord is changed to an E \flat , D, D \flat , C, B, B \flat or A.

This lets guitarists get that heavy drop-tuned tone at different pitches without dealing with floppy string buzz, extra-heavy-gauge strings or expensive extra guitars. The same goes for foam-deadened acoustic guitars or electric violins.

If your singer has a bad throat night, you can drop-tune your guitar to accommodate him without having to change neck position or retune.

The Morpheus DROPTUNE™

pedal also features effect-toggling so you can instantly toggle back and forth between the dropped pitch and the EFFECT OFF for a cool up/down pitch-shift effect during solos or power chord rhythm patterns.

In addition, the DROPTUNE pedal has Full Octave Drop and a great-sounding Octaver.

Don't mistake



this for a mere pitch shift stomp-box. The DROPTUNE uses proprietary polyphonic pitch drop algorithms that maintain perfect harmonic accuracy and tonally-correct overtones — you have to hear this pedal to believe how real it sounds! Not surprising ➔



Extreme Processors • morpheusEFX.com



DROP TUNE:
Polyphonic Drop-Tuning for guitar

www.majormusic.com.au/morpheus

Distributed by:
Major Music
www.majormusic.com.au

DROPTUNE

POLYPHONIC PITCH DROP

considering the DROPTUNE has been developed by a team of guitar effects pros with over fifty total years of experience at other companies where they created some of today's most famous pedals.

With a cast metal chassis, solid positive-feeling steel step switches and non-skid rubber feet, the DROPTUNE is solidly built for years of use and abuse. LED indicators are bright and easy to see.

If you're ready for instant, hassle-free droptuning, listen to the demos on our website...or better yet, try out the DROPTUNE in person at your Morpheus dealer.

- Proprietary polyphonic pitch drop
- Drop tune up to 3½ steps in ½-step decrements
- Full Octave Drop and Octaver
- Latching EFFECT ON/OFF switch
- Momentary DOWN and TOGGLE/UP switches
- Bright backlit DROP TUNE, OCTAVE, OCTAVER, TOGGLE and EFFECT indicators
- Rear panel TRIM LEVEL control with front panel LED level display
- IN, OUT and power supply jacks (power supply included)
- Patent Pending
- Rugged cast-metal chassis
- Two-year limited warranty

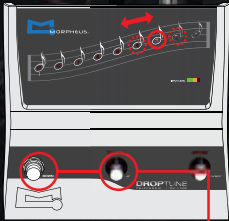

In EFFECT OFF mode, the DOWN switch decrements pitch and the UP switch increments pitch. The note indicators indicate the amount of drop tune. Guitar signal is unaffected until EFFECT ON is selected.

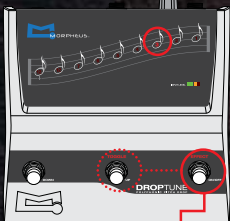

Switching to EFFECT ON engages the selected or previous drop tune setting and also engages the TOGGLE feature. The DOWN switch remains active for decrementing the drop tune.

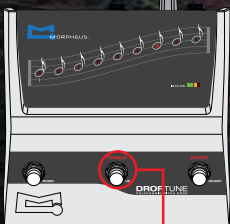

Press/release the TOGGLE switch to switch back and forth between the drop tune setting and the unaffected guitar signal.



Bill Kelliher
and Brent Hinds
of Mastodon



Anders Nyström
of Katatonia

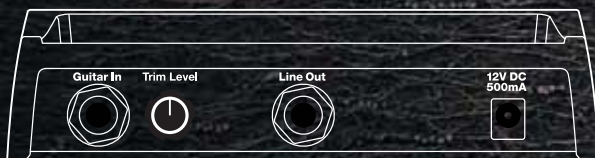

©2010 XP Audio Inc. All Rights Reserved
Morpheus and DropTune are trademarks of XP Audio Inc.
Specifications subject to change. MDT2.0



Extreme Processors • morpheusEFX.com
Salt Lake City, USA • A division of XP Audio Inc. • ph. 801.265.0917

ALSO AVAILABLE:

CAPO - Polyphonic UP-Tuning for guitar

www.majormusic.com.au/morpheus

Distributed by:
Major Music
www.majormusic.com.au

